

Light efficiency:



Output: 2002 lm

Light quality:



Peak: 3086 cd

Power: 19.1 W

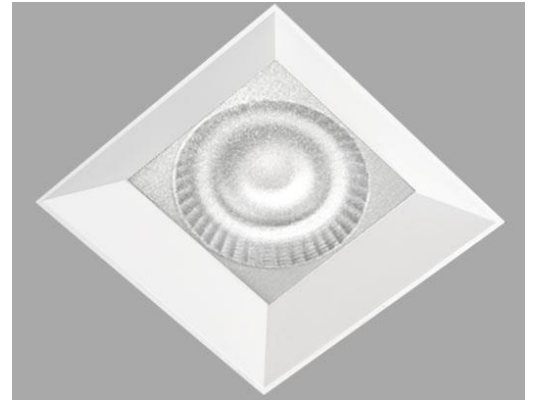

Beam angle

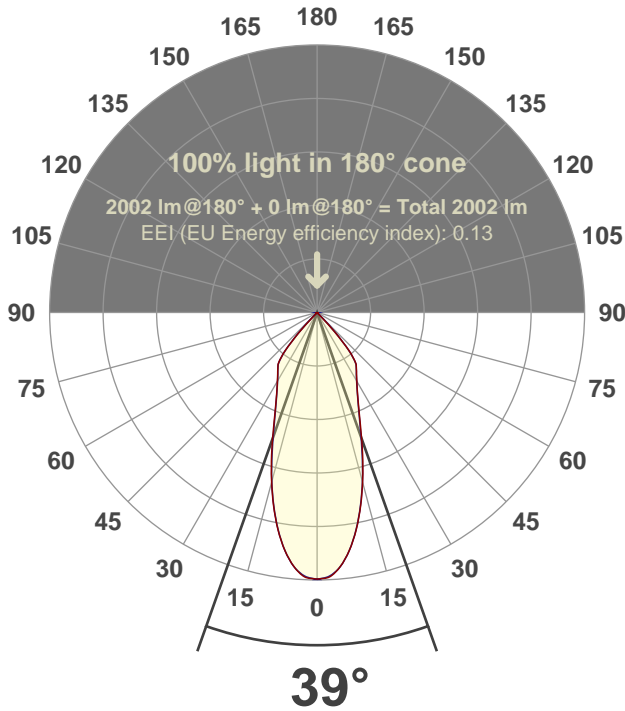

Test number:

CR6D-SF-OR-C16-30K-38°-Rev1

Luminaire Model:

Core 6" Square Open Regress-C16-30k-38°

Date and time:

2/3/2022 9:55:14 PM

LUM: 2002

Spectra

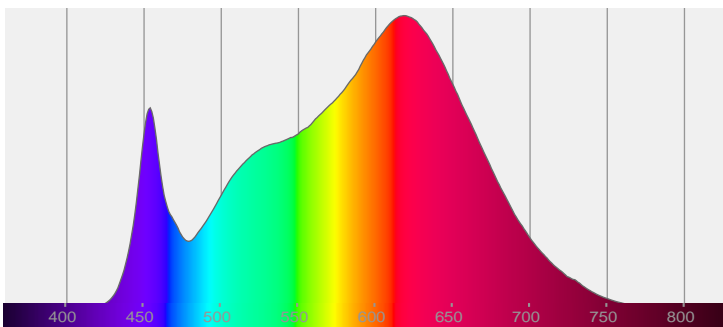

CRI: 94.8 (R1-R8)

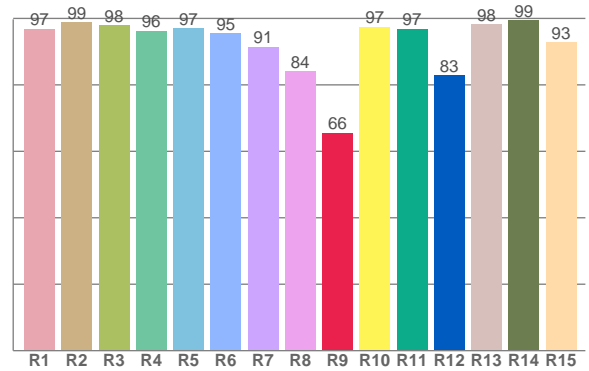

Color parameters

	Color rendering index	Red component	Color fidelity	Color gamut	Color quality scale	Color coordinate cie 1931	Color coordinate cie 1931	Color coordinate	Color coordinate	Color deviation from black body
	CRI	CRI R9	TM30 R _f	TM30 R _g	CQS	x	y	u	v	Δuv
	94.8	65.5	92.1	100.6	91.9	0.425	0.391	0.248	0.343	-0.0034

R_f 92.1

Fidelity index R_f

R_g 100.6

Gammut index R_g

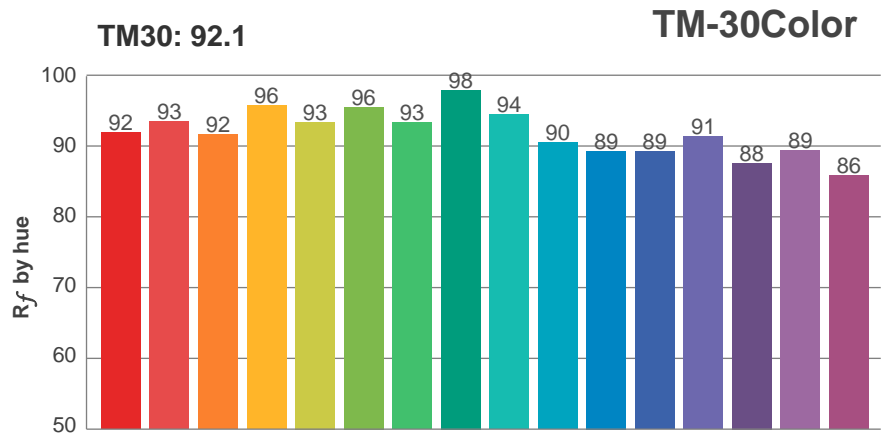

Hue Bin	R_f	Graphic shifts (%)	
		Chroma	Hue
1	92	-4%	0%
2	93	-2%	2%
3	92	0%	4%
4	96	-1%	1%
5	93	-2%	2%
6	96	2%	0%
7	93	-2%	0%
8	98	1%	0%
9	94	-1%	4%
10	90	0%	5%
11	89	3%	7%
12	89	7%	-1%
13	91	3%	-6%
14	88	4%	-9%
15	89	-1%	-6%
16	86	-1%	-11%

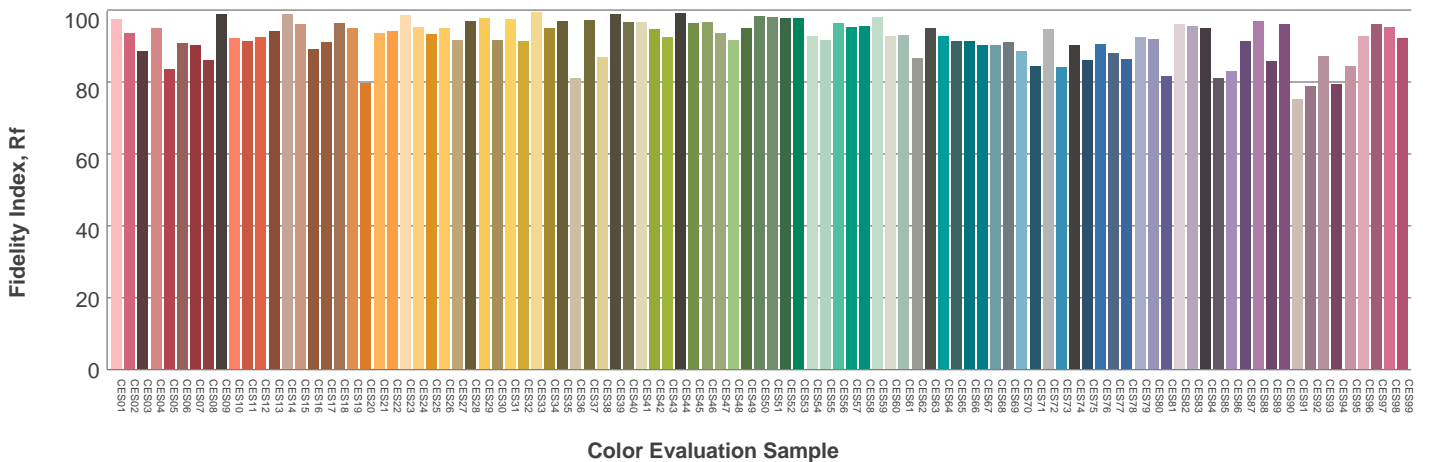
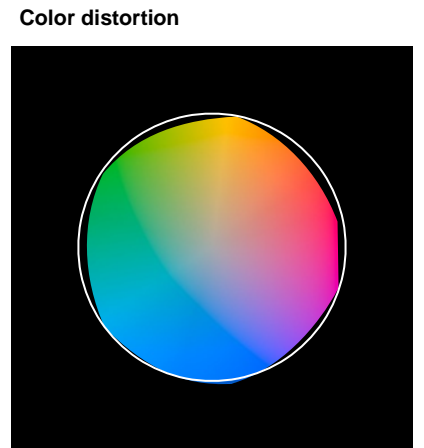
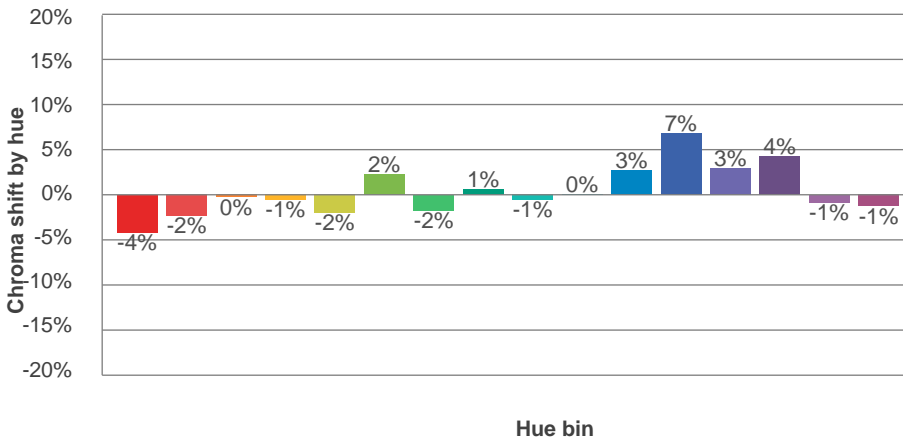
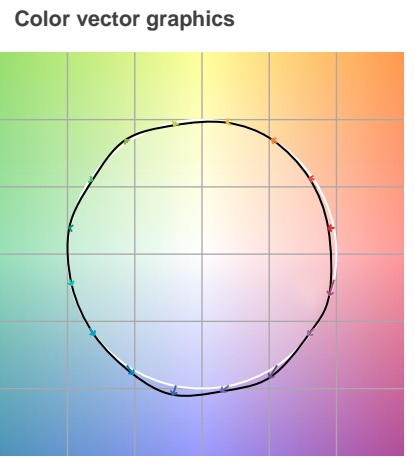
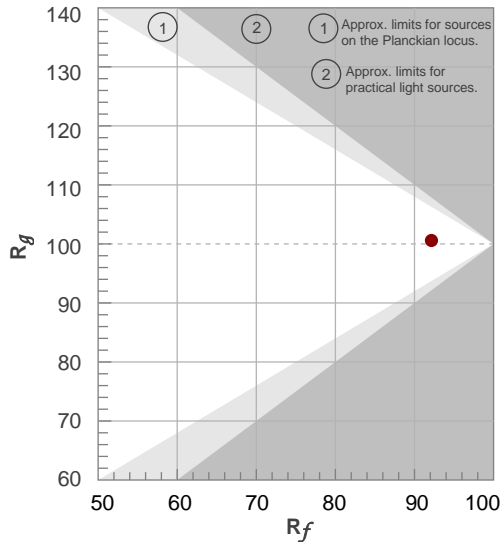

Beam details

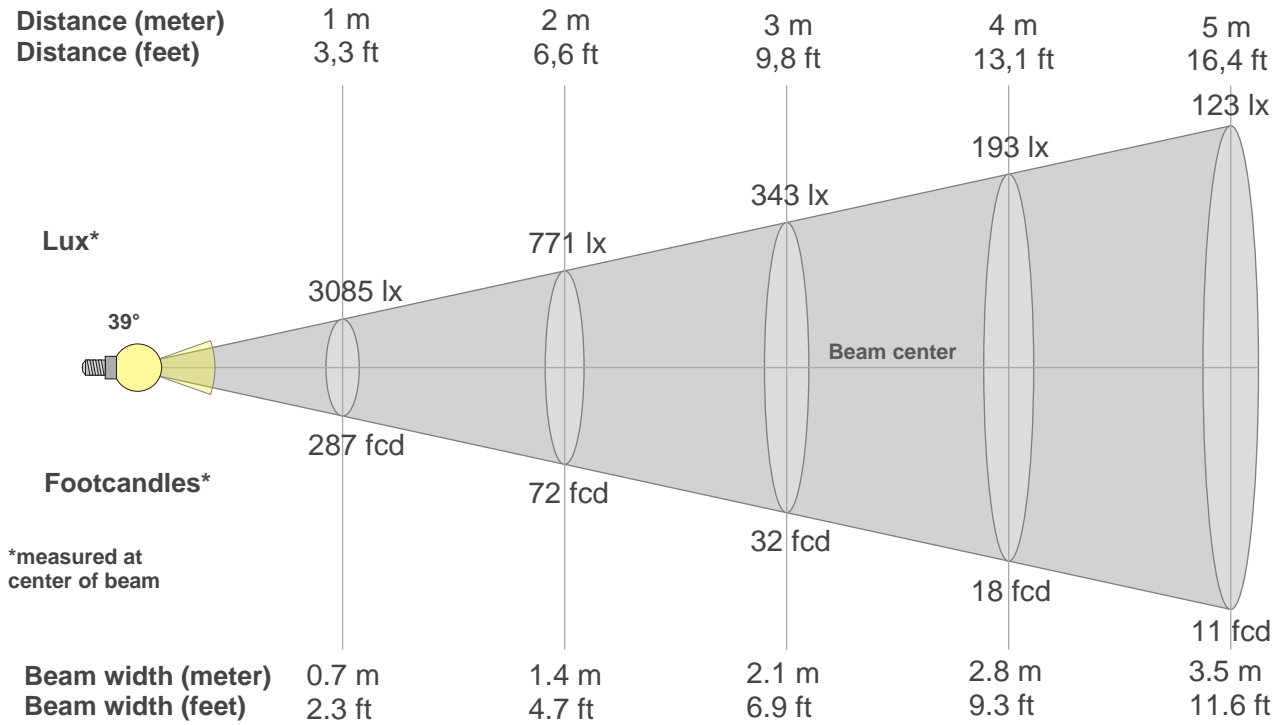

Beam intensities from 1-20m

1m	2m	3m	4m	5m	6m	7m	8m	9m	10m	11m	12m	13m	14m	15m	16m	17m	18m	19m	20m
3.3ft	6.6ft	9.8ft	13.1ft	16.4ft	19.7ft	23ft	26.2ft	29.5ft	32.8ft	36.1ft	39.4ft	42.7ft	45.9ft	49.2ft	52.5ft	55.8ft	59.1ft	62.3ft	65.6ft
3085lx	771lx	343lx	193lx	123lx	86lx	63lx	48lx	38lx	31lx	25lx	21lx	18lx	16lx	14lx	12lx	11lx	10lx	9lx	8lx
286.6fcd	71.7fcd	31.8fcd	17.9fcd	11.5fcd	8fcd	5.8fcd	4.5fcd	3.5fcd	2.9fcd	2.4fcd	2fcd	1.7fcd	1.5fcd	1.3fcd	1.1fcd	1fcd	0.9fcd	0.8fcd	0.7fcd

Intensities in 0° c-plane

0°	2°	4°	6°	8°	10°	12°	14°	16°	18°	20°	22°	24°	26°	28°	30°	32°	34°	36°	38°
3085	3069	3008	2900	2756	2576	2369	2151	1928	1708	1500	1329	1190	1080	992	924	867	818	771	714
100%	99%	97%	94%	89%	83%	77%	70%	62%	55%	49%	43%	39%	35%	32%	30%	28%	27%	25%	23%

Intensities in 90° c-plane

0°	2°	4°	6°	8°	10°	12°	14°	16°	18°	20°	22°	24°	26°	28°	30°	32°	34°	36°	38°
3085	3063	3002	2899	2753	2572	2363	2143	1916	1687	1480	1315	1182	1075	988	918	862	815	768	705
100%	99%	97%	94%	89%	83%	77%	69%	62%	55%	48%	43%	38%	35%	32%	30%	28%	26%	25%	23%

Intensities in 180° c-plane

0°	2°	4°	6°	8°	10°	12°	14°	16°	18°	20°	22°	24°	26°	28°	30°	32°	34°	36°	38°
3085	3069	3008	2900	2756	2576	2369	2151	1928	1708	1500	1329	1190	1080	992	924	867	818	771	714
100%	99%	97%	94%	89%	83%	77%	70%	62%	55%	49%	43%	39%	35%	32%	30%	28%	27%	25%	23%

Intensities in 270° c-plane

0°	2°	4°	6°	8°	10°	12°	14°	16°	18°	20°	22°	24°	26°	28°	30°	32°	34°	36°	38°
3085	3063	3002	2899	2753	2572	2363	2143	1916	1687	1480	1315	1182	1075	988	918	862	815	768	705
100%	99%	97%	94%	89%	83%	77%	69%	62%	55%	48%	43%	38%	35%	32%	30%	28%	26%	25%	23%

Beam angle 50%	Field angle 10%	Cutoff angle 2,5%	Intensity ratio in 120° cone	Intensity ratio in 90° cone
39°	85.7°	91.7°	99.4%	98.4%

LAMPS (number of lamps)
50

Light planning Luminaire budgetary diagram

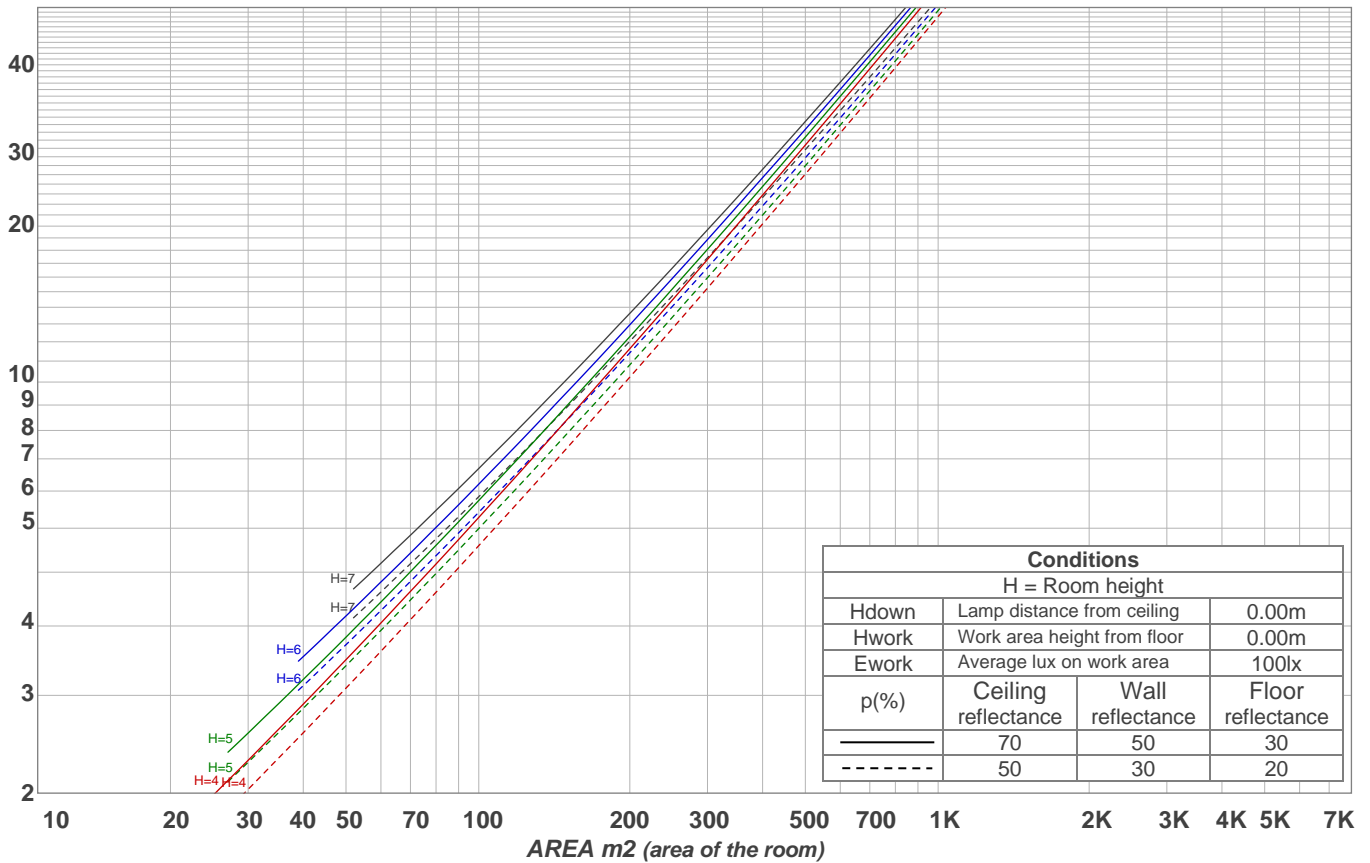

Luminaire budgetary diagram AREA m2 (area of the room) Coefficients of Utilization

Ceiling reflectance	80				70				50			30			10			0			
Wall reflectance	70	50	30	10	70	50	30	10	50	30	10	50	30	10	50	30	10	50	30	10	0
Floor reflectance	20	20	20	20	20	20	20	20	20	20	20	20	20	20	20	20	20	20	20	20	0
RCR	(RCR: Room Cavity Ratio)																				
	Room Values are expressed as percentage of Lumens delivered to the task surface																				
0	119	119	119	119	116	116	116	116	111	111	111	106	106	106	102	102	102	100	100	100	100
1	114	111	108	106	111	109	106	104	105	103	101	101	99	98	97	96	95	94	94	94	94
2	108	103	99	96	106	101	98	95	98	95	93	95	93	91	92	91	89	87	87	87	87
3	103	96	91	87	101	95	90	87	92	88	85	90	87	84	88	85	83	81	81	81	81
4	98	90	85	80	96	89	84	80	87	82	79	85	81	78	83	80	77	76	76	76	76
5	93	84	79	74	91	83	78	74	82	77	73	80	76	73	79	75	72	71	71	71	71
6	88	79	73	69	87	79	73	69	77	72	68	76	71	68	74	71	68	66	66	66	66
7	84	75	69	65	83	74	68	64	73	68	64	72	67	64	70	66	63	62	62	62	62
8	80	70	65	61	79	70	64	60	69	64	60	68	63	60	67	63	60	58	58	58	58
9	76	67	61	57	75	66	61	57	65	60	57	64	60	56	64	59	56	55	55	55	55
10	73	63	57	54	72	63	57	54	62	57	53	61	57	53	60	56	53	52	52	52	52

Zonal Lumen Summary

0°-10°	10°-20°	20°-30°	30°-40°	40°-50°	50°-60°	60°-70°	70°-80°	80°-90°
270 lm	559 lm	526 lm	488 lm	143 lm	4.61 lm	4.07 lm	4.09 lm	3.55 lm
90°-100°	100°-110°	110°-120°	120°-130°	130°-140°	140°-150°	150°-160°	160°-170°	170°-180°
0.000 lm	0.000 lm	0.000 lm	0.000 lm	0.000 lm	0.000 lm	0.000 lm	0.000 lm	0.000 lm