

Light efficiency:



Output: 593 lm

Light quality:



Peak: 1331 cd

Power: 12.1 W

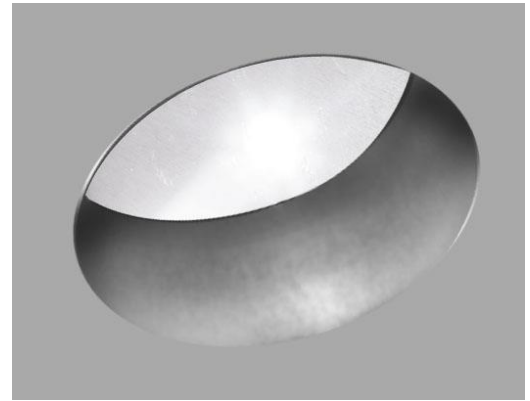

Beam angle

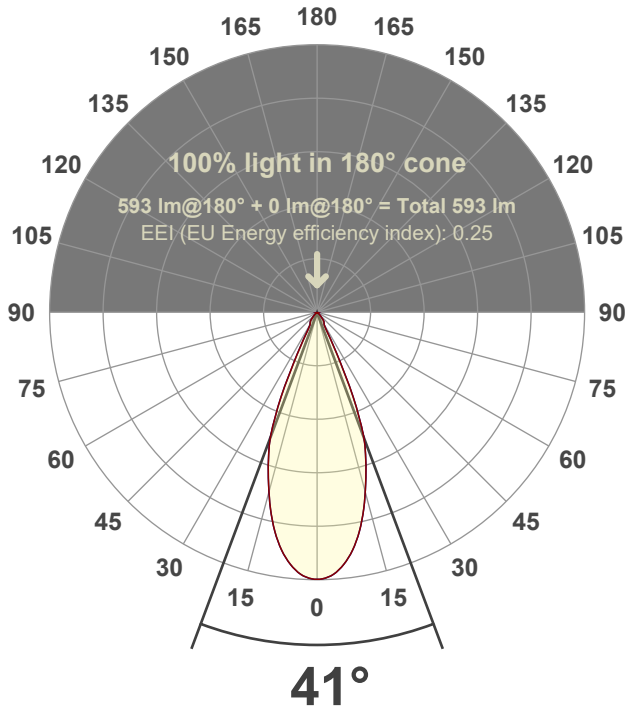

Test number:

RV3D-RA-A11-AD3019-40°-Rev2A

Luminaire Model:

Rivet 3" Round Adjustable Downlight-A11-Ambient Dim 3000k to1900k-40°

Date and time:

1/4/2023 2:47:42 PM

LUM: 593

Spectra

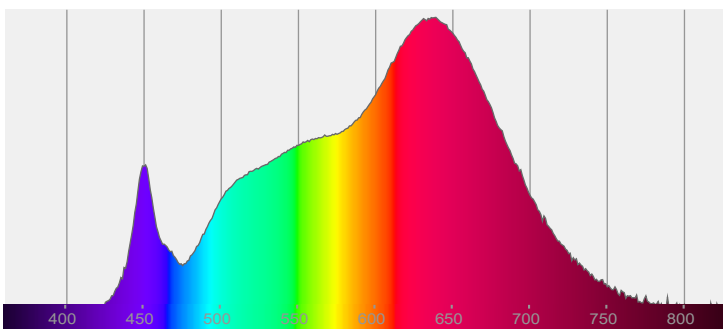

CRI: 96.0 (R1-R8)

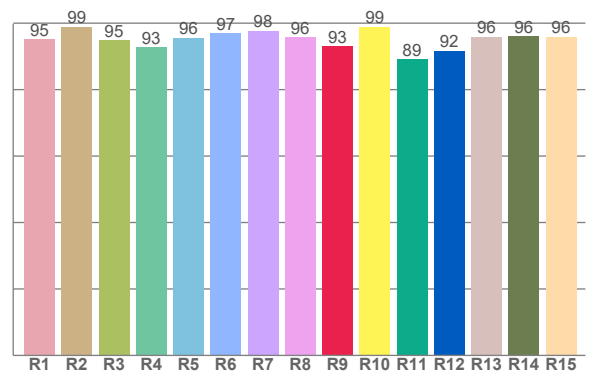

Color parameters

Color rendering index	Red component	Color fidelity	Color gamut	Color quality scale	Color coordinate cie 1931	Color coordinate cie 1931	Color coordinate	Color coordinate	Color divition from black body
CRI	CRI R9	TM30 R _f	TM30 R _g	CQS	x	y	u	v	Δuv
96.0	93.1	95.6	103.8	95.4	0.437	0.401	0.252	0.347	-0.0012

R_f 95.6
Fidelity index R_f

R_g 103.8
Gammut index R_g

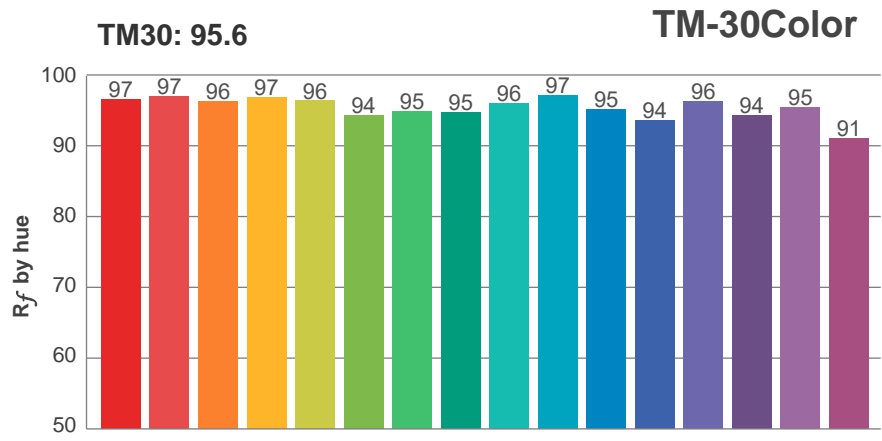

Hue Bin	R_f	Graphic shifts (%)	
		Chroma	Hue
1	97	1%	-1%
2	97	1%	-1%
3	96	1%	0%
4	97	-1%	0%
5	96	1%	2%
6	94	4%	2%
7	95	2%	0%
8	95	3%	-1%
9	96	2%	-1%
10	97	1%	0%
11	95	2%	3%
12	94	3%	1%
13	96	2%	-1%
14	94	4%	-2%
15	95	1%	0%
16	91	4%	-6%

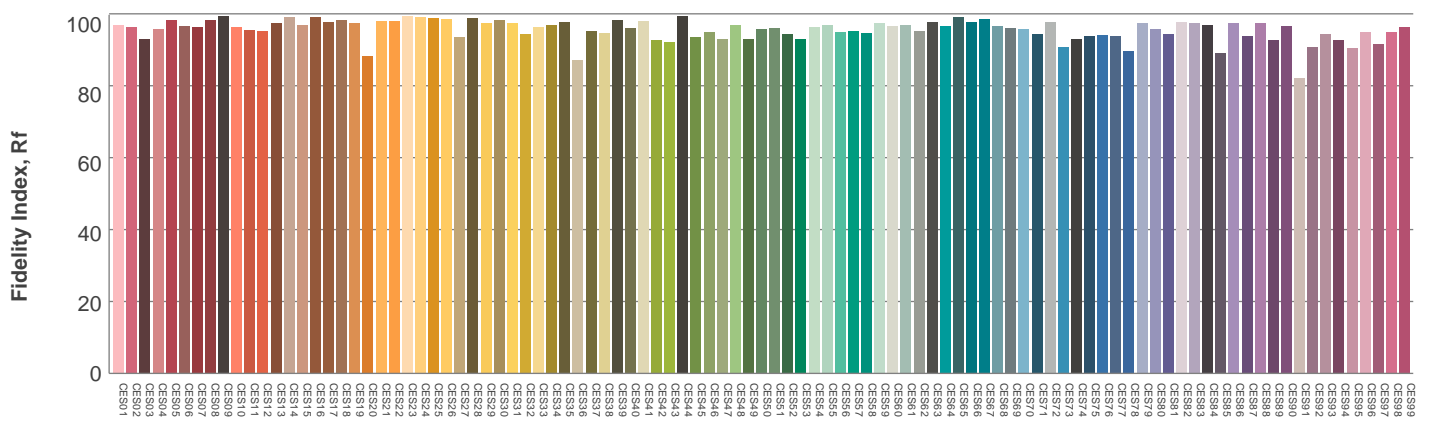
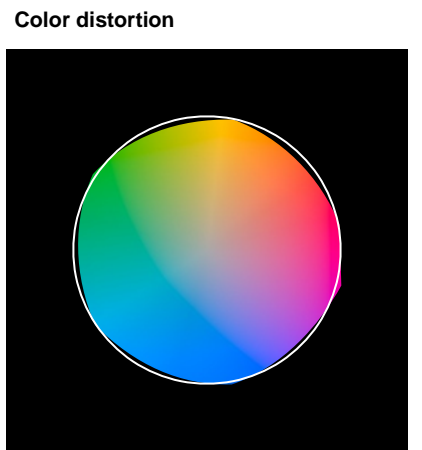
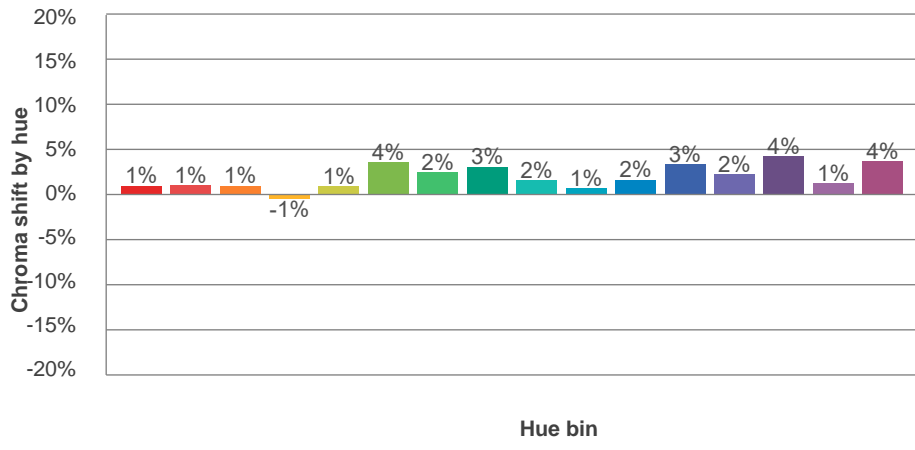
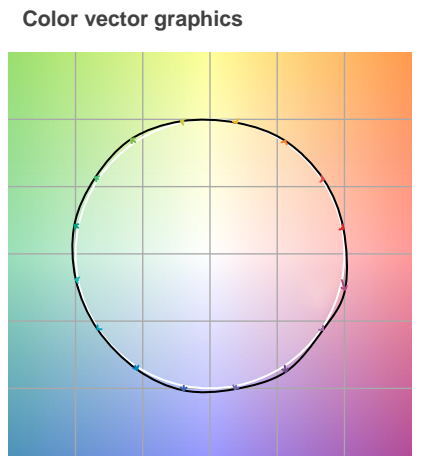
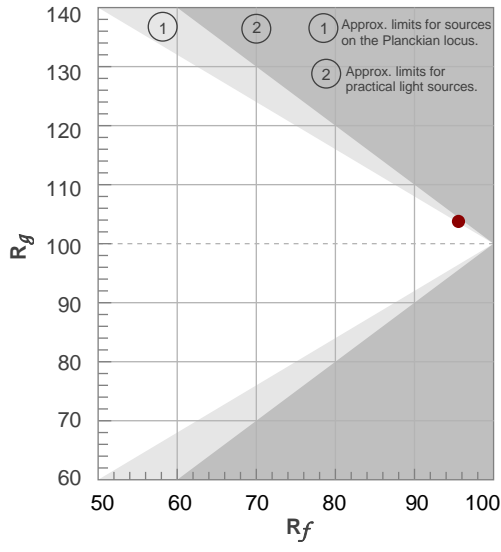

Color Evaluation Sample

www.specialtylightingindustries.com As a result of our continuous improvement, values are subject to change without notice. These are delivered results and can vary +/- 10% from published source data range.

Beam details

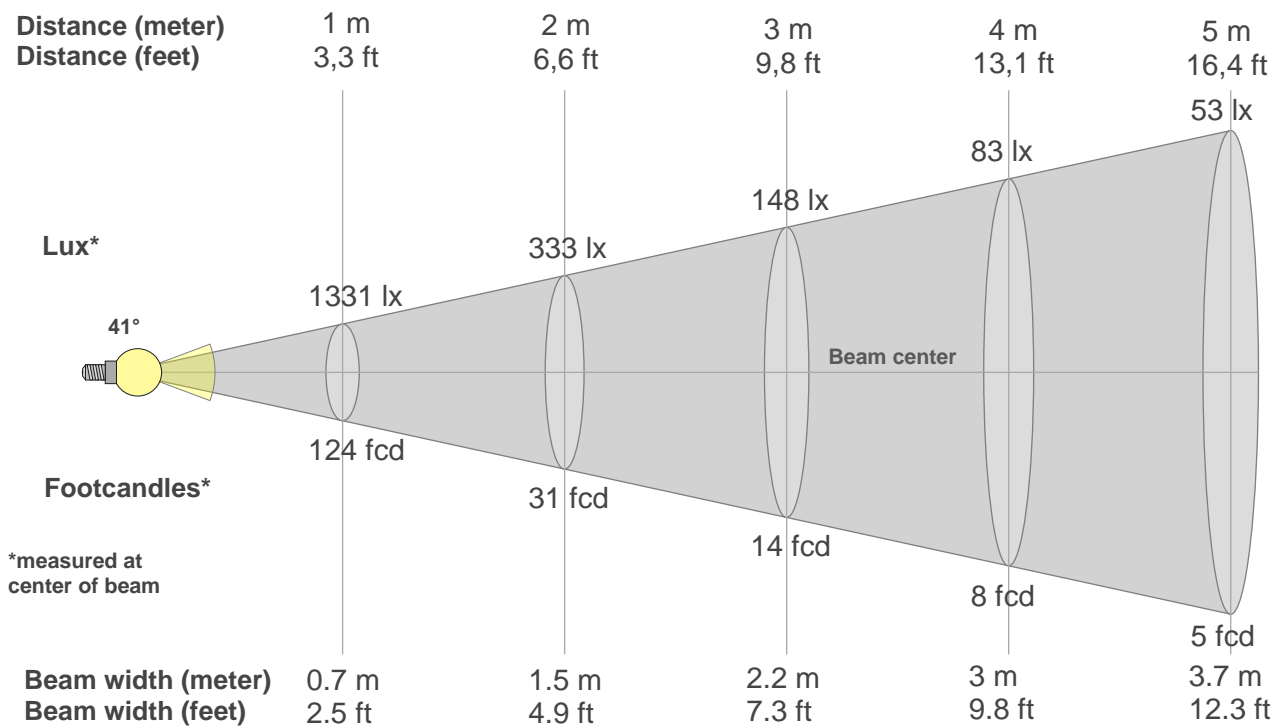

Beam intensities from 1-20m

1m	2m	3m	4m	5m	6m	7m	8m	9m	10m	11m	12m	13m	14m	15m	16m	17m	18m	19m	20m
3.3ft	6.6ft	9.8ft	13.1ft	16.4ft	19.7ft	23ft	26.2ft	29.5ft	32.8ft	36.1ft	39.4ft	42.7ft	45.9ft	49.2ft	52.5ft	55.8ft	59.1ft	62.3ft	65.6ft
1331lx	333lx	148lx	83lx	53lx	37lx	27lx	21lx	16lx	13lx	11lx	9lx	8lx	7lx	6lx	5lx	5lx	4lx	4lx	3lx
123.7fcd	30.9fcd	13.7fcd	7.7fcd	4.9fcd	3.4fcd	2.5fcd	1.9fcd	1.5fcd	1.2fcd	1fcd	0.9fcd	0.7fcd	0.6fcd	0.5fcd	0.5fcd	0.4fcd	0.4fcd	0.3fcd	0.3fcd

Intensities in 0° c-plane

0°	2°	4°	6°	8°	10°	12°	14°	16°	18°	20°	22°	24°	26°	28°	30°	32°	34°	36°	38°
1331	1324	1304	1267	1214	1148	1069	979	883	790	691	553	382	210	100	76	67	62	58	54
100%	99%	98%	95%	91%	86%	80%	74%	66%	59%	52%	42%	29%	16%	8%	6%	5%	5%	4%	4%

Intensities in 90° c-plane

0°	2°	4°	6°	8°	10°	12°	14°	16°	18°	20°	22°	24°	26°	28°	30°	32°	34°	36°	38°
1331	1324	1304	1267	1214	1148	1069	979	883	790	691	553	382	210	100	76	67	62	58	54
100%	99%	98%	95%	91%	86%	80%	74%	66%	59%	52%	42%	29%	16%	8%	6%	5%	5%	4%	4%

Intensities in 180° c-plane

0°	2°	4°	6°	8°	10°	12°	14°	16°	18°	20°	22°	24°	26°	28°	30°	32°	34°	36°	38°
1331	1324	1304	1267	1214	1148	1069	979	883	790	691	553	382	210	100	76	67	62	58	54
100%	99%	98%	95%	91%	86%	80%	74%	66%	59%	52%	42%	29%	16%	8%	6%	5%	5%	4%	4%

Intensities in 270° c-plane

0°	2°	4°	6°	8°	10°	12°	14°	16°	18°	20°	22°	24°	26°	28°	30°	32°	34°	36°	38°
1331	1324	1304	1267	1214	1148	1069	979	883	790	691	553	382	210	100	76	67	62	58	54
100%	99%	98%	95%	91%	86%	80%	74%	66%	59%	52%	42%	29%	16%	8%	6%	5%	5%	4%	4%

Beam angle 50%	Field angle 10%	Cutoff angle 2,5%	Intensity ratio in 120° cone	Intensity ratio in 90° cone
41°	54.8°	85.1°	98.4%	95.3%

LAMPS (number of lamps)
50

Light planning Luminaire budgetary diagram

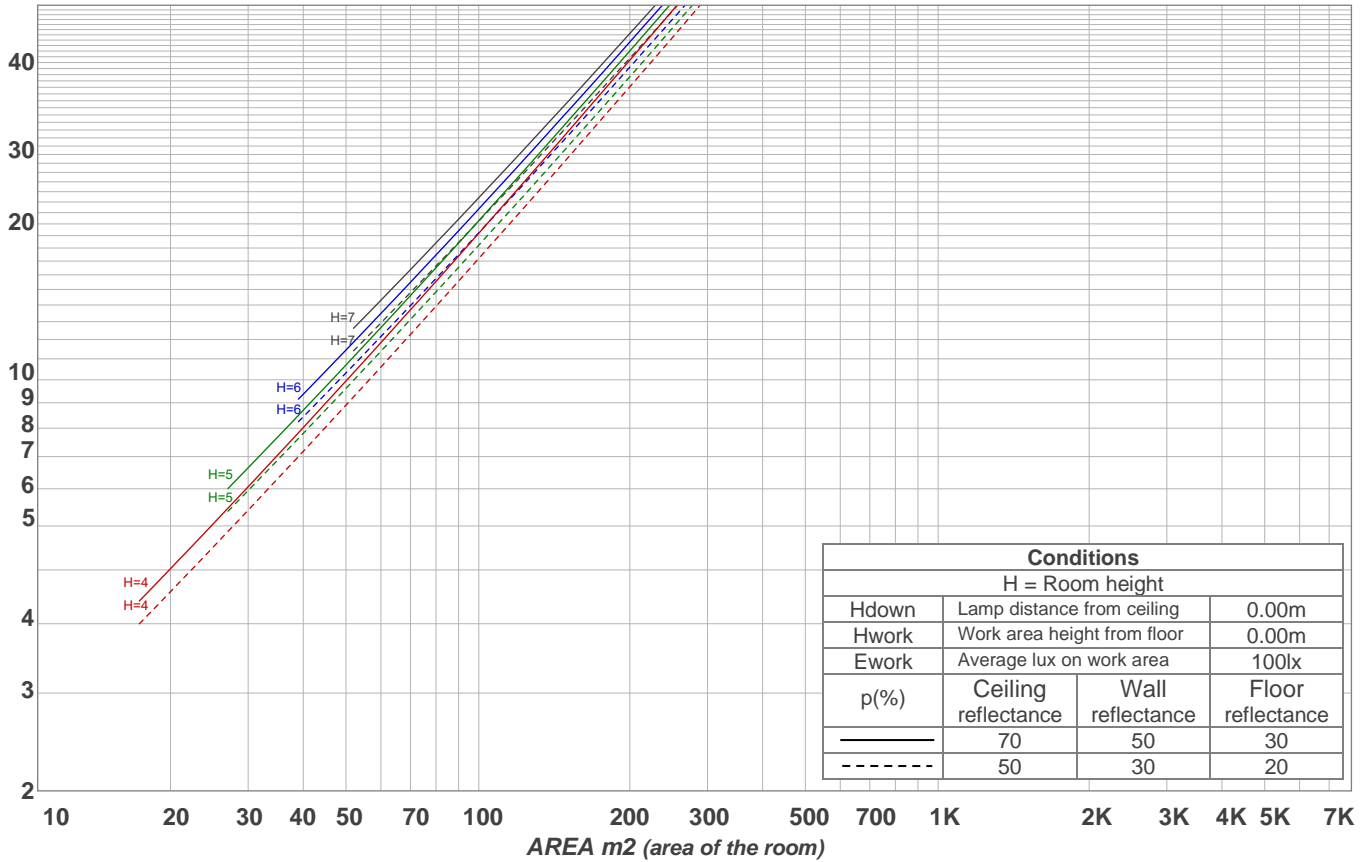

Luminaire budgetary diagram AREA m2 (area of the room) Coefficients of Utilization

Ceiling reflectance	80				70				50			30			10			0			
Wall reflectance	70	50	30	10	70	50	30	10	50	30	10	50	30	10	50	30	10	50	30	10	0
Floor reflectance	20	20	20	20	20	20	20	20	20	20	20	20	20	20	20	20	20	20	20	20	0
RCR	(RCR: Room Cavity Ratio)																				
	Room Values are expressed as percentage of Lumens delivered to the task surface																				
0	119	119	119	119	116	116	116	116	111	111	111	106	106	106	102	102	102	100	100	100	100
1	114	112	109	107	112	109	107	106	105	104	102	102	100	99	98	97	96	95	95	95	95
2	109	105	101	98	107	103	100	97	100	97	95	97	95	93	94	93	91	90	90	90	90
3	105	99	95	91	103	98	94	91	95	92	89	93	90	88	91	88	86	85	85	85	85
4	101	94	89	86	99	93	88	85	91	87	84	89	86	83	87	84	82	81	81	81	81
5	97	89	84	81	95	89	84	80	87	83	80	85	82	79	84	81	78	77	77	77	77
6	93	85	80	77	92	85	80	76	83	79	76	82	78	75	81	77	75	74	74	74	74
7	89	81	76	73	88	81	76	73	80	75	72	79	75	72	78	74	72	70	70	70	70
8	86	78	73	70	85	78	73	69	77	72	69	76	72	69	75	71	69	67	67	67	67
9	83	75	70	67	82	74	70	66	74	69	66	73	69	66	72	68	66	65	65	65	65
10	80	72	67	64	79	72	67	64	71	67	64	70	66	63	69	66	63	62	62	62	62

Zonal Lumen Summary

0°-10°	10°-20°	20°-30°	30°-40°	40°-50°	50°-60°	60°-70°	70°-80°	80°-90°
119 lm	256 lm	140 lm	37.3 lm	21.4 lm	10.0 lm	5.12 lm	2.71 lm	1.63 lm
90°-100°	100°-110°	110°-120°	120°-130°	130°-140°	140°-150°	150°-160°	160°-170°	170°-180°
0.000 lm	0.000 lm	0.000 lm	0.000 lm	0.000 lm	0.000 lm	0.000 lm	0.000 lm	0.000 lm