

Light efficiency:



Output: 1541 lm

Light quality:



Peak: 4094 cd

Power: 20.4 W



Beam angle

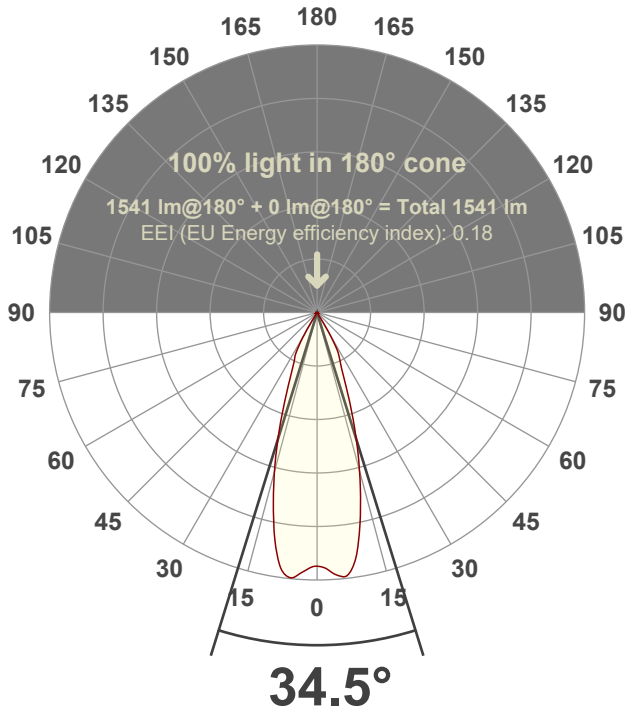

Test number:

MSC-H-M-C20-30k-35°

Luminaire Model:

Mosaic Medium Accent Head C20-30k-35°

Date and time:

8/31/2022 10:10:31 AM

LUM: 1541

Spectra

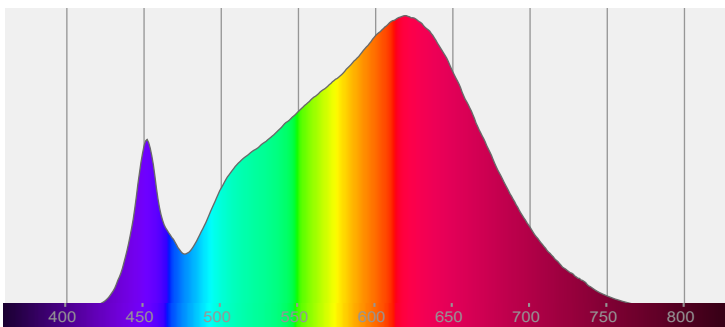

CRI: 92.0 (R1-R8)

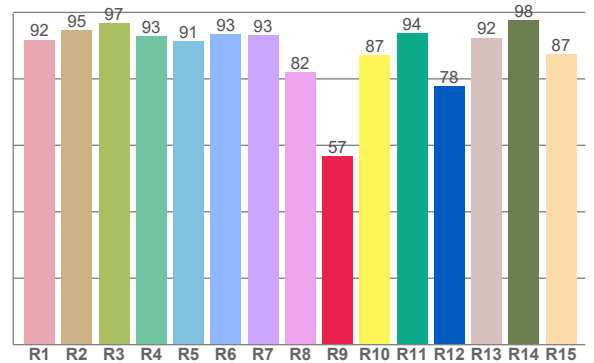

Color parameters

	Color rendering index	Red component	Color fidelity	Color gamut	Color quality scale	Color coordinate cie 1931	Color coordinate cie 1931	Color coordinate	Color coordinate	Color divition from black body
	CRI	CRI R9	TM30 R _f	TM30 R _g	CQS	x	y	u	v	Δuv
	92.0	56.6	91.7	99.0	91.0	0.431	0.406	0.246	0.348	0.0017

R_f 91.7

Fidelity index R_f

R_g 99.0

Gammut index R_g

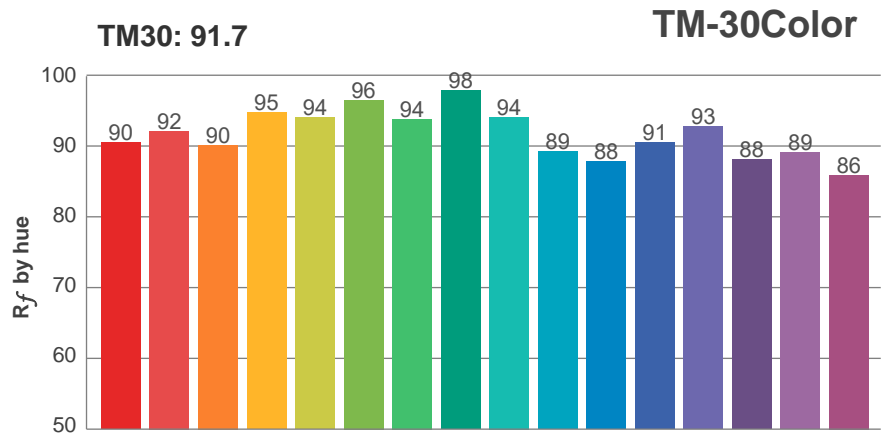

Hue Bin	R _f	Graphic shifts (%)	
		Chroma	Hue
1	90	-5%	-1%
2	92	-4%	2%
3	90	-2%	5%
4	95	-1%	3%
5	94	-2%	2%
6	96	2%	0%
7	94	-2%	-2%
8	98	-1%	0%
9	94	-3%	3%
10	89	-2%	6%
11	88	1%	8%
12	91	6%	1%
13	93	3%	-4%
14	88	5%	-8%
15	89	-1%	-7%
16	86	-2%	-11%

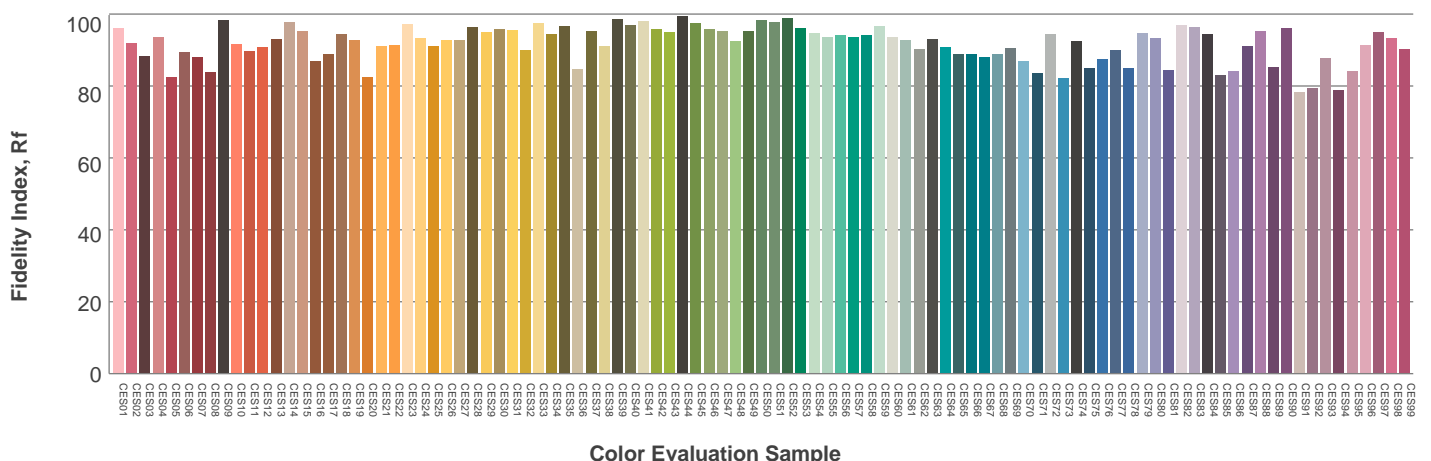
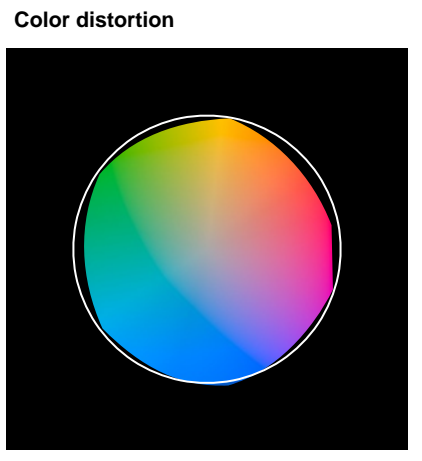
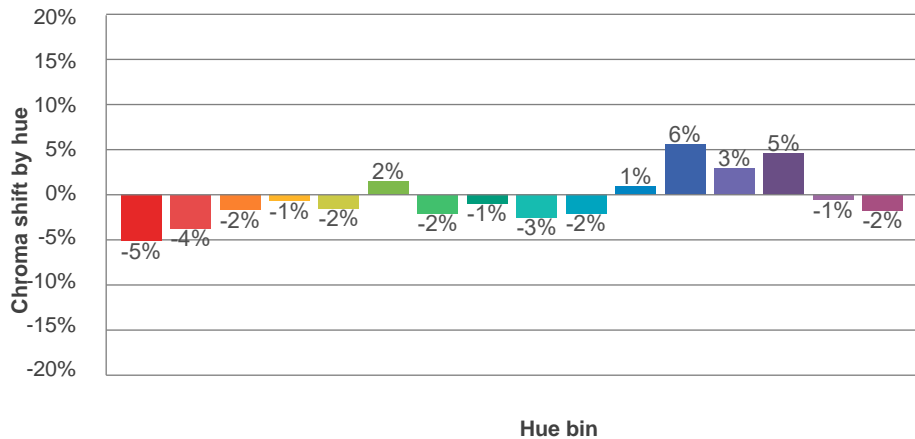
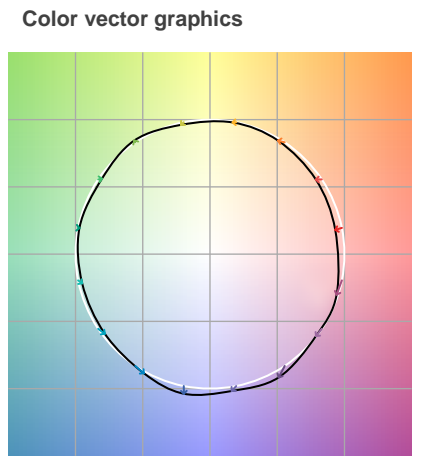
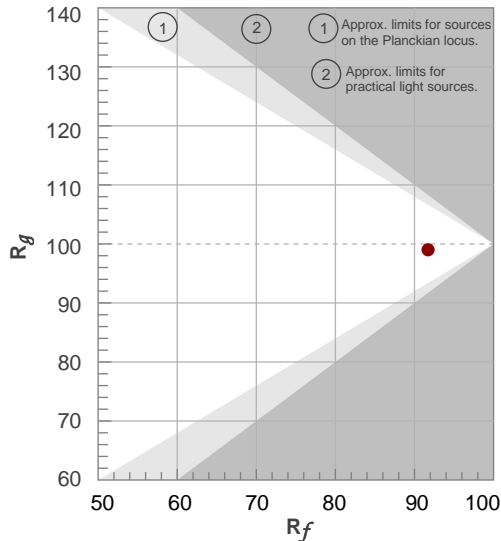

Beam details

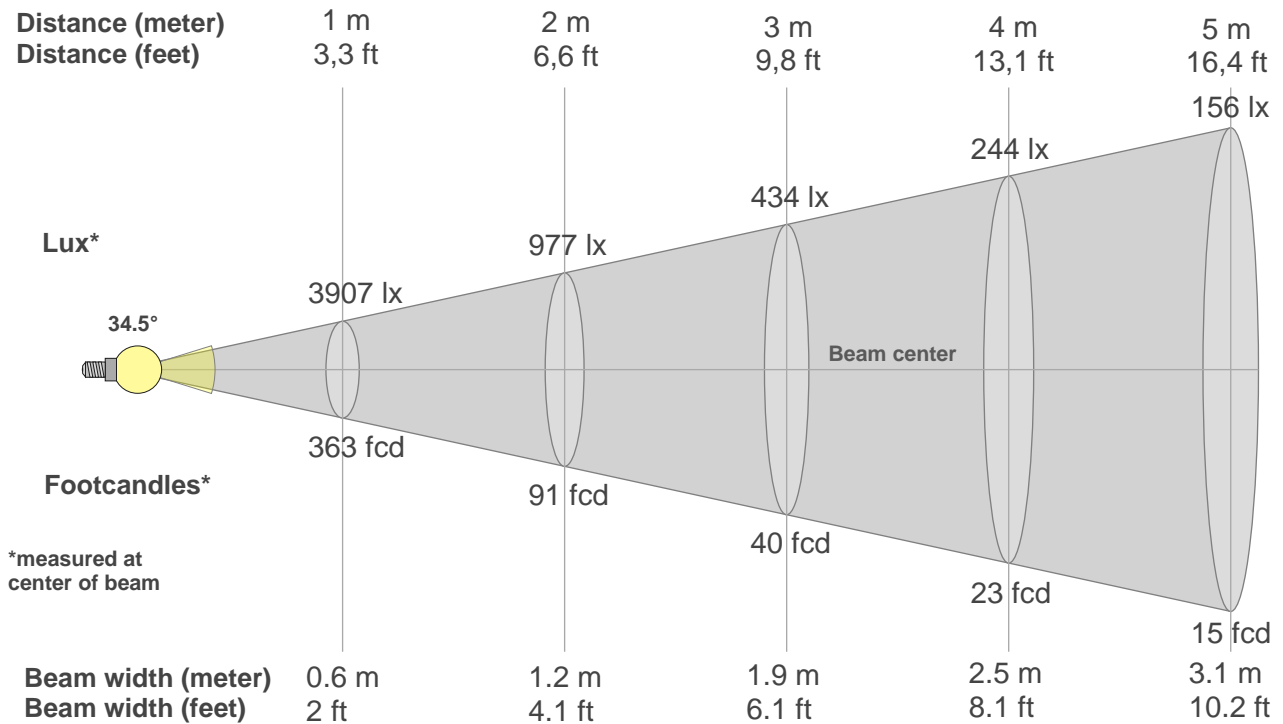

Beam intensities from 1-20m

1m	2m	3m	4m	5m	6m	7m	8m	9m	10m	11m	12m	13m	14m	15m	16m	17m	18m	19m	20m
3.3ft	6.6ft	9.8ft	13.1ft	16.4ft	19.7ft	23ft	26.2ft	29.5ft	32.8ft	36.1ft	39.4ft	42.7ft	45.9ft	49.2ft	52.5ft	55.8ft	59.1ft	62.3ft	65.6ft
3907lx	977lx	434lx	244lx	156lx	109lx	80lx	61lx	48lx	39lx	32lx	27lx	23lx	20lx	17lx	15lx	14lx	12lx	11lx	10lx
363fcd	90.7fcd	40.3fcd	22.7fcd	14.5fcd	10.1fcd	7.4fcd	5.7fcd	4.5fcd	3.6fcd	3fcd	2.5fcd	2.1fcd	1.9fcd	1.6fcd	1.4fcd	1.3fcd	1.1fcd	1fcd	0.9fcd

Intensities in 0° c-plane

0°	2°	4°	6°	8°	10°	12°	14°	16°	18°	20°	22°	24°	26°	28°	30°	32°	34°	36°	38°
3907	3937	4031	4058	3917	3614	3199	2750	2310	1883	1490	1161	924	796	674	468	238	61	10	5
100%	101%	103%	104%	100%	93%	82%	70%	59%	48%	38%	30%	24%	20%	17%	12%	6%	2%	0%	0%

Intensities in 90° c-plane

0°	2°	4°	6°	8°	10°	12°	14°	16°	18°	20°	22°	24°	26°	28°	30°	32°	34°	36°	38°
3907	3937	4031	4058	3917	3614	3199	2750	2310	1883	1490	1161	924	796	674	468	238	61	10	5
100%	101%	103%	104%	100%	93%	82%	70%	59%	48%	38%	30%	24%	20%	17%	12%	6%	2%	0%	0%

Intensities in 180° c-plane

0°	2°	4°	6°	8°	10°	12°	14°	16°	18°	20°	22°	24°	26°	28°	30°	32°	34°	36°	38°
3907	3946	4024	4076	3970	3644	3222	2768	2319	1878	1478	1165	941	793	676	469	233	80	14	5
100%	101%	103%	104%	102%	93%	82%	71%	59%	48%	38%	30%	24%	20%	17%	12%	6%	2%	0%	0%

Intensities in 270° c-plane

0°	2°	4°	6°	8°	10°	12°	14°	16°	18°	20°	22°	24°	26°	28°	30°	32°	34°	36°	38°
3907	3946	4024	4076	3970	3644	3222	2768	2319	1878	1478	1165	941	793	676	469	233	80	14	5
100%	101%	103%	104%	102%	93%	82%	71%	59%	48%	38%	30%	24%	20%	17%	12%	6%	2%	0%	0%

Beam angle 50%	Field angle 10%	Cutoff angle 2,5%	Intensity ratio in 120° cone	Intensity ratio in 90° cone
34.5°	61°	66.8°	99.5%	99.3%

LAMPS (number of lamps)
50

Light planning Luminaire budgetary diagram

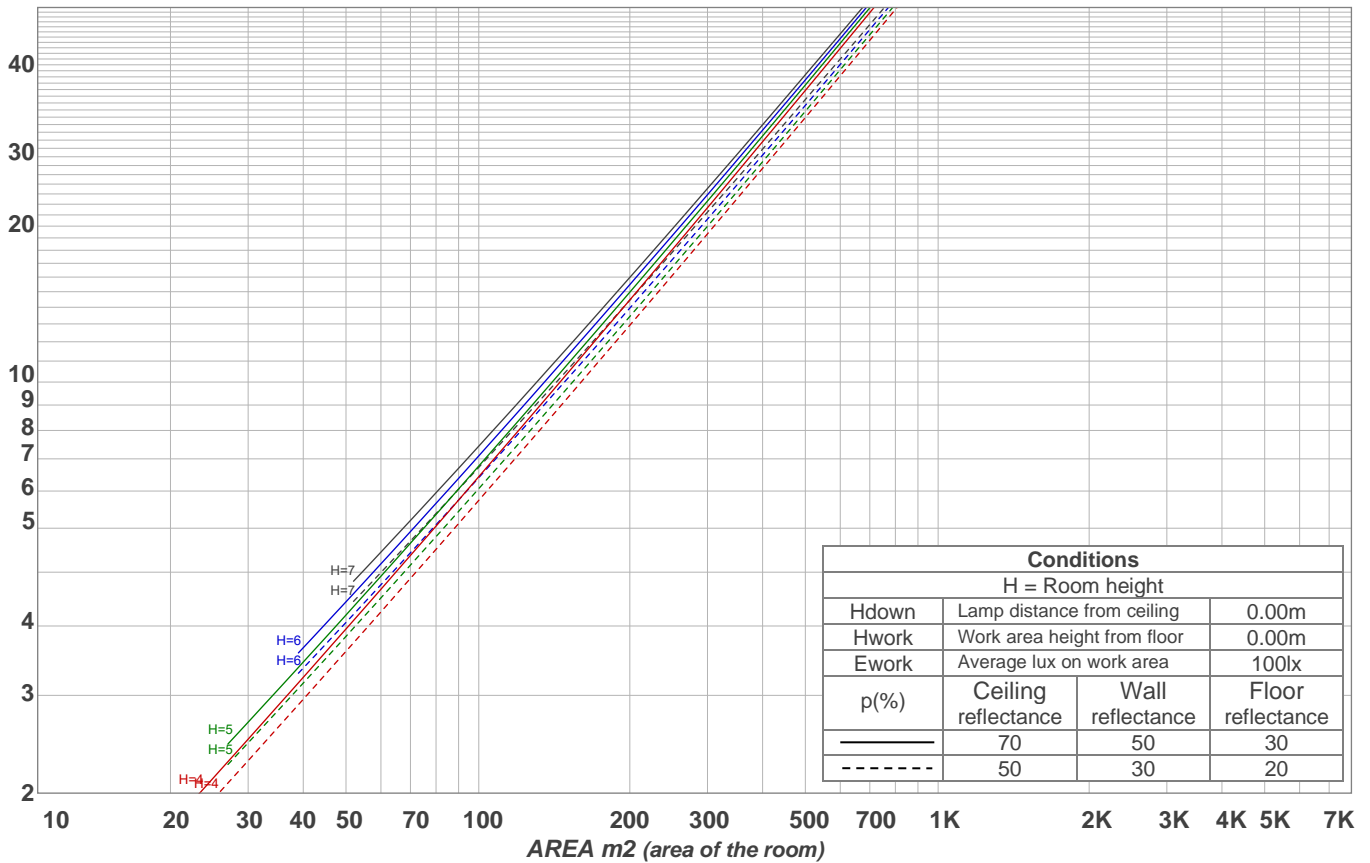

Luminaire budgetary diagram AREA m2 (area of the room) Coefficients of Utilization

Ceiling reflectance	80				70				50			30			10			0			
Wall reflectance	70	50	30	10	70	50	30	10	50	30	10	50	30	10	50	30	10	50	30	10	0
Floor reflectance	20	20	20	20	20	20	20	20	20	20	20	20	20	20	20	20	20	20	20	20	0
RCR	(RCR: Room Cavity Ratio)																				
	Room Values are expressed as percentage of Lumens delivered to the task surface																				
0	119	119	119	119	116	116	116	116	111	111	111	106	106	106	102	102	102	100	100	100	
1	115	112	110	108	112	110	108	107	106	105	103	102	101	100	99	98	97	96	96	96	
2	110	106	103	100	108	105	102	99	102	99	97	99	97	95	96	95	93	92	92	92	
3	106	101	97	94	105	100	96	94	98	95	92	95	93	91	93	91	89	88	88	88	
4	103	97	93	89	101	96	92	89	94	90	88	92	89	87	90	88	86	85	85	85	
5	99	93	88	85	98	92	88	85	90	87	84	89	86	83	87	85	82	81	81	81	
6	96	89	84	81	95	88	84	81	87	83	80	86	82	80	84	82	79	78	78	78	
7	93	86	81	78	92	85	81	78	84	80	77	83	79	77	82	79	76	75	75	75	
8	90	82	78	75	89	82	78	75	81	77	74	80	76	74	79	76	74	73	73	73	
9	87	79	75	72	86	79	75	72	78	74	72	77	74	71	77	73	71	70	70	70	
10	84	77	72	69	83	76	72	69	76	72	69	75	71	69	74	71	69	68	68	68	

Zonal Lumen Summary

0°-10°	10°-20°	20°-30°	30°-40°	40°-50°	50°-60°	60°-70°	70°-80°	80°-90°
377 lm	688 lm	404 lm	59.9 lm	1.84 lm	1.62 lm	1.94 lm	2.40 lm	3.74 lm
90°-100°	100°-110°	110°-120°	120°-130°	130°-140°	140°-150°	150°-160°	160°-170°	170°-180°
0.000 lm	0.000 lm	0.000 lm	0.000 lm	0.000 lm	0.000 lm	0.000 lm	0.000 lm	0.000 lm